

PHF TB1210X0.75

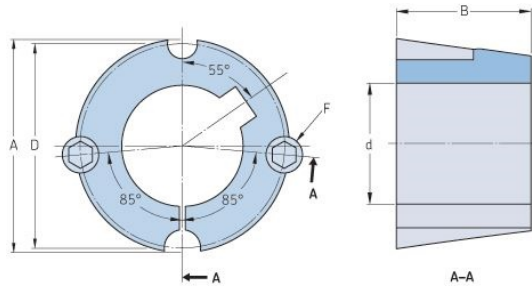

Bushing no.	TB1210
d = Bore diameter (mm)	19
Bore diameter (in)	0.75
Keyway width (mm)	4.8
Keyway width (in)	0.19
Keyway depth (mm)	2.4
Keyway depth (in)	0.09
A (mm)	47.6
A (in)	1.87
B (mm)	25.4
B (in)	1
D (mm)	44.5
D (in)	1.75
E (mm)	-
E (in)	-
F (mm)	9.525 x 15.875
F (in)	-
Weight (kg)	0.22
Weight (lbs)	0.49