

PHF TB1215X1.125

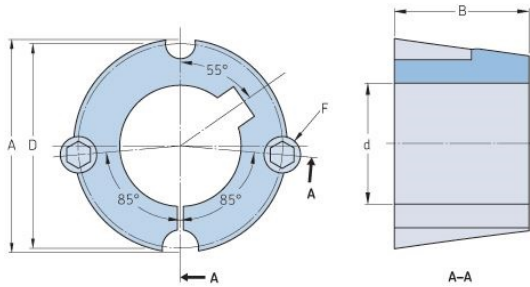

Bushing no.	TB1215
d = Bore diameter (mm)	29
Bore diameter (in)	1.14
Keyway width (mm)	7.9
Keyway width (in)	0.31
Keyway depth (mm)	3.2
Keyway depth (in)	0.13
A (mm)	47.6
A (in)	1.87
B (mm)	38.1
B (in)	1.5
D (mm)	44.5
D (in)	1.75
E (mm)	-
E (in)	-
F (mm)	9.525 x 15.875
F (in)	-
Weight (kg)	0.25
Weight (lbs)	0.55