

PHF TB1108X12MM

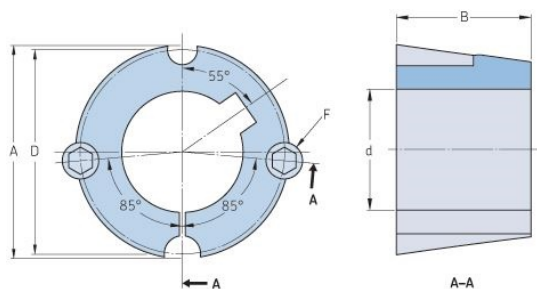

Bushing no.	TB1108
d = Bore diameter (mm)	12
Bore diameter (in)	0.47
Keyway width (mm)	4
Keyway width (in)	0.16
Keyway depth (mm)	1.8
Keyway depth (in)	0.07
A (mm)	38.4
A (in)	1.51
B (mm)	22.2
B (in)	0.87
D (mm)	36.9
D (in)	1.45
E (mm)	-
E (in)	-
F (mm)	6.350 x 12.700
F (in)	-
Weight (kg)	0.14
Weight (lbs)	0.31