

# PHF TB2012X50MM

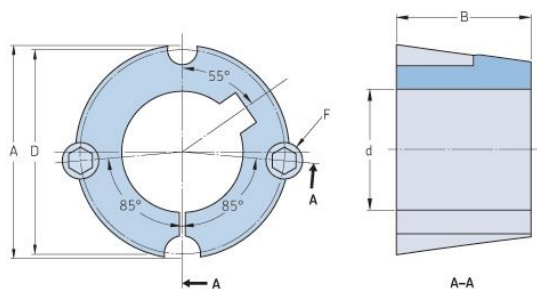

Bushing no.	TB2012
d = Bore diameter (mm)	50
Bore diameter (in)	1.97
Keyway width (mm)	14
Keyway width (in)	0.55
Keyway depth (mm)	3.8
Keyway depth (in)	0.15
A (mm)	69.9
A (in)	2.75
B (mm)	31.8
B (in)	1.25
D (mm)	66.7
D (in)	2.63
E (mm)	-
E (in)	-
F (mm)	11.113 x 22.225
F (in)	-
Weight (kg)	0.32
Weight (lbs)	0.71