

# PHF TB2017X42MM

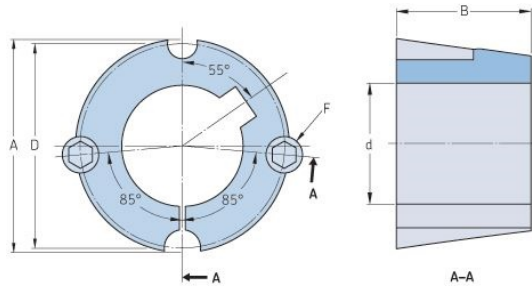

Bushing no.	TB2017
d = Bore diameter (mm)	42
Bore diameter (in)	1.65
Keyway width (mm)	12
Keyway width (in)	0.47
Keyway depth (mm)	3.3
Keyway depth (in)	0.13
A (mm)	69.9
A (in)	2.75
B (mm)	44.5
B (in)	1.75
D (mm)	66.7
D (in)	2.63
E (mm)	-
E (in)	-
F (mm)	11.113 x 22.225
F (in)	-
Weight (kg)	0.64
Weight (lbs)	1.41