

# PHF TB3020X25MM

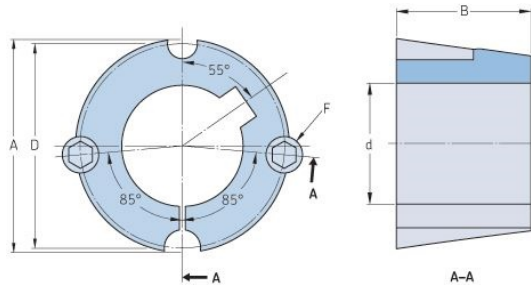

Bushing no.	TB3020
d = Bore diameter (mm)	25
Bore diameter (in)	0.98
Keyway width (mm)	8
Keyway width (in)	0.31
Keyway depth (mm)	3.3
Keyway depth (in)	0.13
A (mm)	108
A (in)	4.25
B (mm)	50.8
B (in)	2
D (mm)	101.6
D (in)	4
E (mm)	-
E (in)	-
F (mm)	15.875 x 31.750
F (in)	-
Weight (kg)	2.77
Weight (lbs)	6.11