

PHE L075HUB

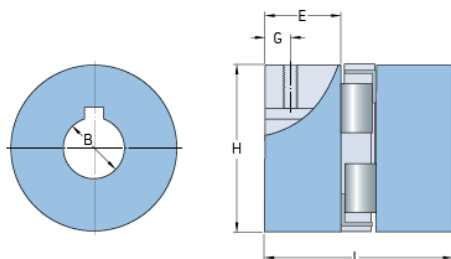

Size	75
Position threaded hole G (mm)	9
Position threaded hole G (in)	0.35
Outer diameter H (mm)	44.5
Outer diameter H (in)	1.75
Maximum bore	24
Maximum bore (in)	-
Set screw	M6
Length E (mm)	21
Length E (in)	0.83
Bore	9
Bore (in)	0.35